

TĀKINA EVENTS

---

# AUDIO-VISUAL SYSTEMS AT TĀKINA

## TĀKINA EVENTS

# AUDIO VISUAL EVENT SERVICES

Tākina Events boasts an experienced and professional audio-visual event services department, that can facilitate a range of exclusive technical production resource and provide support services throughout your eventing journey.

The Plenary Halls and Meeting Rooms located on Level 1 and Level 2 at Tākina feature permanently installed, user friendly and intuitive audio-visual systems, allowing for ease of use, quality, and reliability, without the labour resource generally associated to install, test, and remove it, on a per event basis.

This includes networked and integrated AV systems, including laser projectors, motorised projection screens, audio reinforcement (PA's), and microphones. This equipment is included within the venue rental hire agreement, therefore is commonly referred to as 'Standard AV Inclusions'.

The following table on Pages 3 - 4 provides an overview of the available standard AV Inclusions that Tākina Events has to offer. A more comprehensive breakout down of the included equipment and services is also provided on pages 6 - 20 within this document.

Recommended presentation lighting and staging is available to book on your event at an additional cost - noted within the following table.

Hybrid and virtual technology solutions are available, along with additional options to enhance your event experience, and our friendly team of AV Coordinators will be happy to discuss these with you.

Unless provided by an approved AV supplier, if you intend to use your own equipment on the day, all equipment will require approval from Tākina Events. Approval is required at least 14 days prior to the event and may be subject to an inspection to ensure the equipment adheres to Tākina brand expectations and health and safety requirements.

For any queries, please don't hesitate to contact the Audio-Visual Event Services Team -

[AVECTeam@takinaevents.co.nz](mailto:AVECTeam@takinaevents.co.nz)

For more information on Tākina Wellington Convention and Exhibition Centre and access to general event planning guides, please check out the [Tākina - Website](#) online, and the available [Tākina - Toolkit](#)

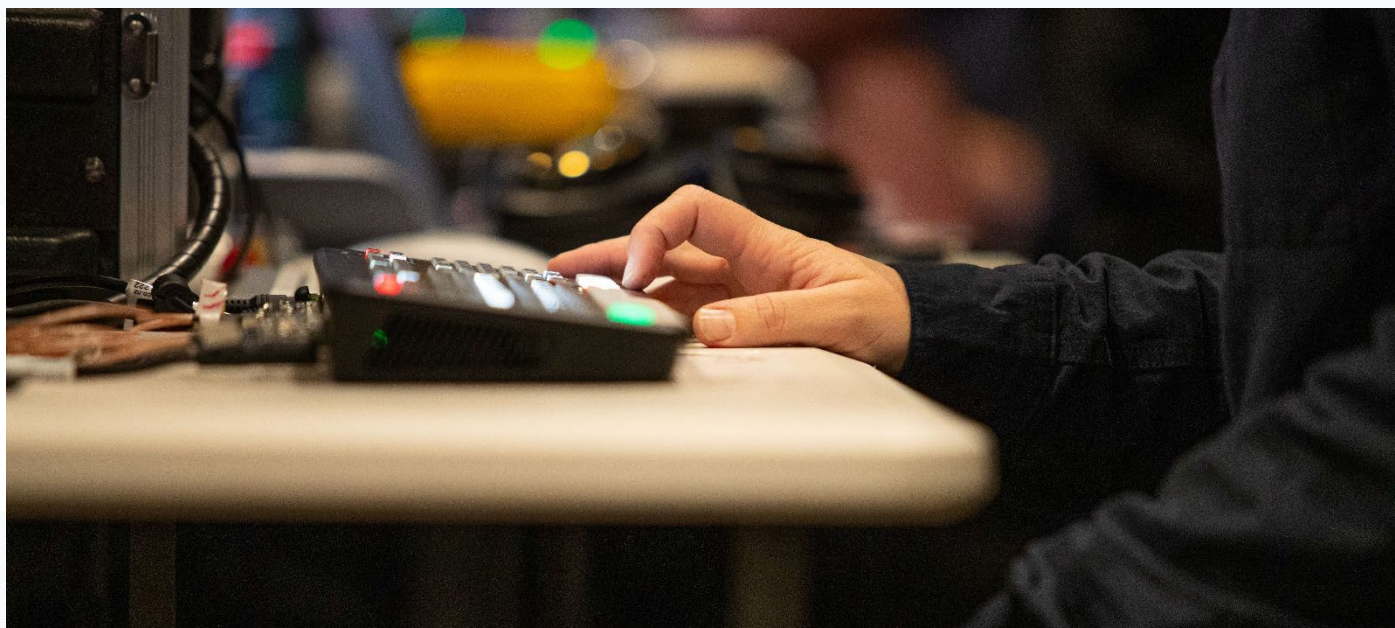

## Tākina – Standard AV Inclusions, production lighting, and staging

Space	Standard AV inclusions									Additional costs	
Tākina	Projector	Projector Spec	Screen	Screen Size	Sound	Lectern Mic	Hand held Mic	Lapel Mic	Comfort Monitor	Presentation Lighting	Stage Size (m)
Rongomātāne Foyer	-	-	-	-	Yes	-	-	-	-	-	-
Rongomātāne Full	2	Laser 12000 Lumen HD	2	5.5m x 3.1m	Yes	Yes	6	3	1	Wash Front/Top (\$450)	8m x 3m (\$750)
Rongomātāne C	1	Laser 12000 Lumen HD	1	5.5m x 3.1m	Yes	Yes	6	1	1	Wash Front/Top (\$250)	6m x 2m (\$375)
Rongomātāne B	-	-	-	-	Yes	-	1	1	-	-	-
Rongomātāne A	1	Laser 12000 Lumen HD	1	5.5m x 3.1m	Yes	Yes	2	1	1	Wash Front/Top (\$250)	6m x 2m (\$375)
Rongomātāne A & B	1	Laser 12000 Lumen HD	1	5.5m x 3.1m	Yes	Yes	4	2	1	Wash Front/Top (\$250)	6m x 2m (\$375)
Matiu 1A	1	Laser 12000 Lumen HD	1	4.4m x 2.5m	Yes	Yes	2	1	1	Wash – Front (\$150)	6m x 2m (\$375)
Mokopuna 1B	1	Laser 5000 Lumen HD	1	3.3m x 1.8m	Yes	Yes	1	1	1	-	-
Mākaro 1C	1	Laser 5000 Lumen HD	1	3.3m x 1.8m	Yes	Yes	1	1	1	-	-
Organiser Office	-	-	-	-	-	-	-	-	-	-	-
Tāwhirimātea foyer	-	-	-	-	Yes	-	-	-	-	-	-
Tāwhirimātea full	2	Laser 20000 Lumen HD	2	7.1m x 4m	Yes	Yes	8	4	1	Wash Front/Top (\$650)	12m x 3m (\$1,050)
Tāwhirimātea C & E	2	Laser 16000 Lumen HD	2	7.1m x 4m	Yes	Yes	4	2	1	Wash Front/Top (\$450)	8m x 3m (\$750)
Tāwhirimātea A & G	2	Laser 20000 Lumen HD	2	7.1m x 4m	Yes	Yes	4	2	1	Wash Front/Top (\$450)	8m x 3m (\$750)
Tāwhirimātea C	1	Laser 16000 Lumen HD	1	7.1m x 4m	Yes	Yes	2	1	1	Wash – Front/Top (\$250)	6m x 2m (\$375)
Tāwhirimātea B	-	-	-	-	Yes	-	1	1	1	-	-
Tāwhirimātea A	1	Laser 20000 Lumen HD	1	7.1m x 4m	Yes	Yes	2	1	1	Wash Front/Top (\$250)	6m x 2m (\$375)
Tāwhirimātea E	1	Laser 16000 Lumen HD	1	7.1m x 4m	Yes	Yes	2	1	1	Wash Front/Top (\$250)	6m x 2m (\$375)

*Please note - Costs are exclusive of GST and based on a 1-day rate. Consecutive days are charged at 50% of the stated cost.*

Tākina – Standard AV inclusions, production lighting, and staging

Space	Standard AV Inclusions									Additional costs	
Tākina	Projector	Projector Spec	Screen	Screen Size	Sound	Lectern Mic	Handheld Mic	Lapel Mic	Comfort Monitor	Presentation Lighting	Stage pieces
Te Matapuna O Te Ora F	-	-	-	-	Yes	-	-	-	-	-	-
Te Matapuna O Te Ora G	1	Laser 20000 Lumen HD	1	7.1m x 4m	Yes	Yes	2	1	1	Wash – Front/Top (\$250)	6m x 2m (\$375)
Whāitaitai 2A	1	Laser 12000 Lumen HD	1	4.4m x 2.5m	Yes	Yes	2	1	1	Wash – Front (\$150)	6m x 2m (\$375)
Organiser Office	-	-	-	-	-	-	-	-	-	-	-

Please note - Costs are exclusive of GST and based on a 1-day rate. Consecutive days are charged at 50% of the stated cost.

TĀKINA EVENTS – AUDIO VISUAL  
TE MĀWEHE - LEVEL ONE

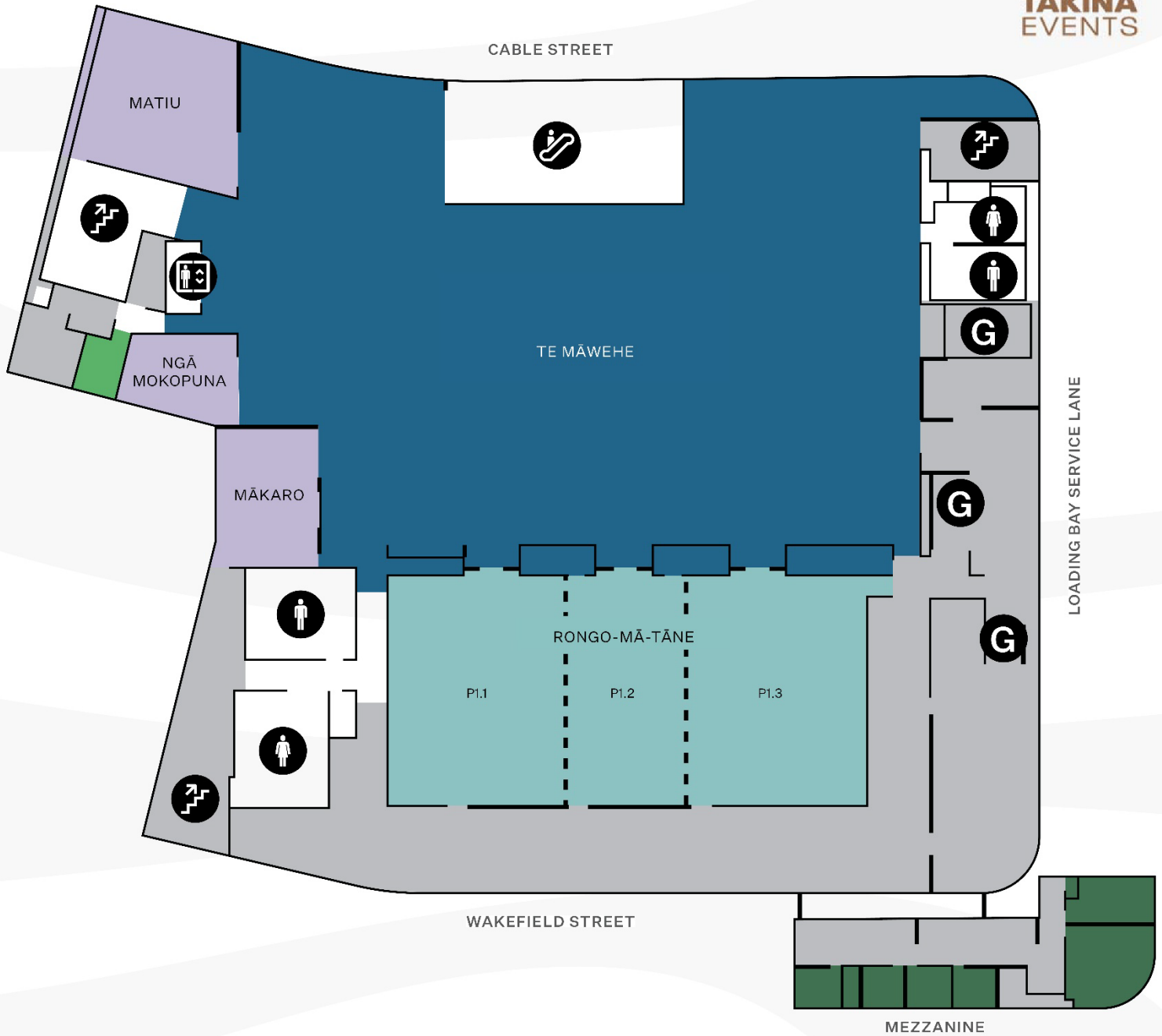

	STAIRS		RONGOMĀTĀNE		ORGANISER OFFICE
	LIFT		RONGOMĀTĀNE FOYER		GREEN ROOM
	ESCALATOR		MEETING ROOMS		BACK OF HOUSE
	GOODS LIFT				
	TOILET				

## RONGOMĀTĀNE FOYER – LEVEL 1

Audio Reinforcement System	1	QSC DSP, Amplifier, 53 x QSC AD-C6T ceiling speakers
Control System	1	QSC Control and QSC Touch Panels
Room Lighting	1	House Lights

## RONGOMĀTĀNE C

Projection Screen	1	Screen Technics 275", 5.5m x 3.1m (16:9 ratio)
12000 Lumen High Brightness Laser Projector, Flown	1	Panasonic PT- RZ120 WUXGA
Presentation Computer installed in Rack	1	HP SFF PC
Audio Reinforcement System	1	QSC DSP, Amplifiers, 2 x QSC KW152 Program speakers 18 x QSC AD-C6T ceiling speakers
Control System, Touch Panel, Wall Mounted	2	QSC Control and QSC Touch Panels
Room Lighting	1	House Lights
Digital Signage Lectern	1	Lectrum L20, Panasonic 43" monitor & Brightsign
Lectern Microphone	1	Shure 412/C-X
Black Laptop Plinth	1	Portable (Lockable Wheels)
Presentation Remote Slide Advancer with Laser Pointer	1	Logitech R700
Keyboard and Mouse	1	HP wireless keyboard and mouse, Extron USB extender
Presenter Foldback Monitor Screen 22inch	1	HP z22, SVSI receiver
HDMI Input at Lectern for Guest Device	1	SVSI Wallplate
PC Audio for Guest Device	1	SVSI Wallplate
Wireless Handheld Microphone	1	Shure MXW2/SM58
Wireless Lapel Microphone	1	Shure MXW1/WL184

## RONGOMĀTĀNE B

Audio Reinforcement System	1	QSC DSP, Amplifiers, 2 x QSC KW122 Program speakers 12 x QSC AD-C6T ceiling speakers
Control System, Touch Panel, Wall Mounted	1	QSC Control and QSC Touch Panels
Room Lighting	1	House Lights
HDMI Input for Guest Device	1	SVSI Wallplate
PC Audio for Guest Device	1	SVSI Wallplate
Wireless Handheld Microphone	1	Shure MXW2/SM58
Wireless Lapel Microphone	1	Shure MXW1/WL184

## RONGOMĀTĀNE A

Projection Screen	1	Screen Technics 275", 5.5m x 3.1m (16:9 ratio)
12000 Lumen High Brightness Laser Projector, Flown	1	Panasonic PT- RZ120 WUXGA
Presentation Computer installed in Rack	1	HP SFF PC
Audio Reinforcement System	1	QSC DSP, Amplifiers, 2 x QSC KW152 Program speakers 18 x QSC AD-C6T ceiling speakers
Control System, Touch Panel, Wall Mounted	2	QSC Control and QSC Touch Panels
Room Lighting	1	House Lights
Digital Signage Lectern	1	Lectrum L20, Panasonic 43" monitor & Brightsign
Lectern Microphone	1	Shure 412/C-X
Black Laptop Plinth	1	Portable (Lockable Wheels)
Presentation Remote Slide Advancer with Laser Pointer	1	Logitech R700
Keyboard and Mouse	1	HP wireless keyboard and mouse, Extron USB extender
Presenter Foldback Monitor Screen 22inch	1	HP z22, SVSI receiver
HDMI Input at Lectern for Guest Device	1	SVSI Wallplate
PC Audio for Guest Device	1	SVSI Wallplate
Wireless Handheld Microphone	1	Shure MXW2/SM58
Wireless Lapel Microphone	1	Shure MXW1/WL184



## RONGOMĀTĀNE FULL

Projection Screen	2	Screen Technics 275", 5.5m x 3.1m (16:9 ratio)
12000 Lumen High Brightness Laser Projector, Flown	2	Panasonic PT- RZ120 WUXGA
Presentation Computer installed in Rack	1	HP SFF PC
Audio Reinforcement System	1	QSC DSP, Amplifiers, 6 x QSC KW152 Program speakers 48 x QSC AD-C6T ceiling speakers
Control System, Touch Panel, Wall Mounted	1	QSC Control and QSC Touch Panels
Room Lighting	1	House Lights
Digital Signage Lectern	1	Lectrum L20, Panasonic 43" monitor & Brightsign
Lectern Microphone	1	Shure 412/C-X
Black Laptop Plinth	1	Portable (Lockable Wheels)
Presentation Remote Slide Advancer with Laser Pointer	1	Logitech R700
Keyboard and Mouse	1	HP wireless keyboard and mouse, Extron USB extender
Presenter Foldback Monitor Screen 22inch	1	HP z22, SVSI receiver
HDMI Input at Lectern for Guest Device	1	SVSI Wallplate
PC Audio for Guest Device	1	SVSI Wallplate
Wireless Handheld Microphone	6	Shure MXW2/SM58
Wireless Lapel Microphone	3	Shure MXW1/WL184



**RONGOMĀTĀNE A & B**

Projection Screen	1	Screen Technics 275", 5.5m x 3.1m (16:9 ratio)
12000 Lumen High Brightness Laser Projector, Flown	1	Panasonic PT- RZ120 WUXGA
Presentation Computer installed in Rack	1	HP SFF PC
Audio Reinforcement System	1	QSC DSP, Amplifiers, 2 x QSC KW152 Program speakers 18 x QSC AD-C6T ceiling speakers
Control System, Touch Panel, Wall Mounted	2	QSC Control and QSC Touch Panels
Room Lighting	1	House Lights
Digital Signage Lectern	1	Lectrum L20, Panasonic 43" monitor & Brightsign
Lectern Microphone	1	Shure 412/C-X
Black Laptop Plinth	1	Portable (Lockable Wheels)
Presentation Remote Slide Advancer with Laser Pointer	1	Logitech R700
Keyboard and Mouse	1	HP wireless keyboard and mouse, Extron USB extender
Presenter Foldback Monitor Screen 22inch	1	HP z22, SVSI receiver
HDMI Input at Lectern for Guest Device	1	SVSI Wallplate
PC Audio for Guest Device	1	SVSI Wallplate
Wireless Handheld Microphone	4	Shure MXW2/SM58
Wireless Lapel Microphone	2	Shure MXW1/WL184

## MATIU 1A

Projection Screen	1	Screen Technics 0620029-D, 200" 4.4m x 2.5m (16:9 ratio)
12,000 Lumen High Brightness Laser Projector, Flown	1	Panasonic PT-RZ120 WUXGA
Presentation Computer installed in Rack	1	HP SFF PC
Audio Reinforcement System	1	QSC DSP, Amplifiers, 2 x QSC AD-S8T Program speakers 8 x QSC AD-C6Tceiling speakers
Control System, Touch Panel, Wall Mounted	2	QSC Control and QSC Touch Panels
Room Lighting	1	House Lights
Digital Signage Lectern	1	Lectrum L20, Panasonic 43" monitor & Brightsign
Lectern Microphone	1	Shure 412/C-X
Black Laptop Plinth	1	Portable (Lockable Wheels)
Presentation Remote Slide Advancer with Laser Pointer	1	Logitech R700
Keyboard and Mouse	1	HP wireless keyboard and mouse, Extron USB extender
Presenter Foldback Monitor Screen 22inch	1	HP z22, SVSI receiver
HDMI Input at Lectern for Guest Device	1	SVSI Wallplate
PC Audio for Guest Device	1	SVSI Wallplate
Wireless Handheld Microphone	2	Shure MXW2/SM58
Wireless Lapel Microphone	1	Shure MXW1

## MOKOPUNA 1B

Projection Screen	1	Screen Technics 0615029-BR, 150" 3.3m x1.8m (16:9 ratio)
5000 Lumen High Brightness Laser Projector, Flown	1	Panasonic PT-FRZ50 WUXGA
Presentation Computer installed in Rack	1	HP SFF PC
Audio Reinforcement System	1	QSC DSP, Amplifiers, 2 x QSC AD-S6T Program speakers 4 X QSC AD-C6Tceiling speakers
Control System, Touch Panel, Wall Mounted	2	QSC Control and QSC Touch Panels
Room Lighting	1	House Lights
Digital Signage Lectern	1	Lectrum L20, Panasonic 43" monitor & Brightsign
Lectern Microphone	1	Shure 412/C-X
Black Laptop Plinth	1	Portable (Lockable Wheels)
Presentation Remote Slide Advancer with Laser Pointer	1	Logitech R700
Keyboard and Mouse	1	HP wireless keyboard and mouse, Extron USB extender
Presenter Foldback Monitor Screen 22inch	1	HP z22, SVSI receiver
HDMI Input at Lectern for Guest Device	1	SVSI Wallplate
PC Audio for Guest Device	1	SVSI Wallplate
Wireless Handheld Microphone	1	Shure MXW2/SM58
Wireless Lapel Microphone	1	Shure MXW1

## MĀKARO 1C

Projection Screen	1	Screen Technics 0615029-BR, 150" 3.3m x1.8m (16:9 ratio)
5000 Lumen High Brightness Laser Projector, Flown	1	Panasonic PT-FRZ50 WUXGA
Presentation Computer installed in Rack	1	HP SFF PC
Audio Reinforcement System	1	QSC DSP, Amplifiers, 2 x QSC AD-S6T Program speakers 4 X QSC AD-C6Tceiling speakers
Control System, Touch Panel, Wall Mounted	2	QSC Control and QSC Touch Panels
Room Lighting	1	House Lights
Digital Signage Lectern	1	Lectrum L20, Panasonic 43" monitor & Brightsign
Lectern Microphone	1	Shure 412/C-X
Black Laptop Plinth	1	Portable (Lockable Wheels)
Presentation Remote Slide Advancer with Laser Pointer	1	Logitech R700
Keyboard and Mouse	1	HP wireless keyboard and mouse, Extron USB extender
Presenter Foldback Monitor Screen 22inch	1	HP z22, SVSI receiver
HDMI Input at Lectern for Guest Device	1	SVSI Wallplate
PC Audio for Guest Device	1	SVSI Wallplate
Wireless Handheld Microphone	1	Shure MXW2/SM58
Wireless Lapel Microphone	1	Shure MXW1

TĀKINA EVENTS – AUDIO VISUAL  
TE MATAPUNA O TE ORA - LEVEL TWO

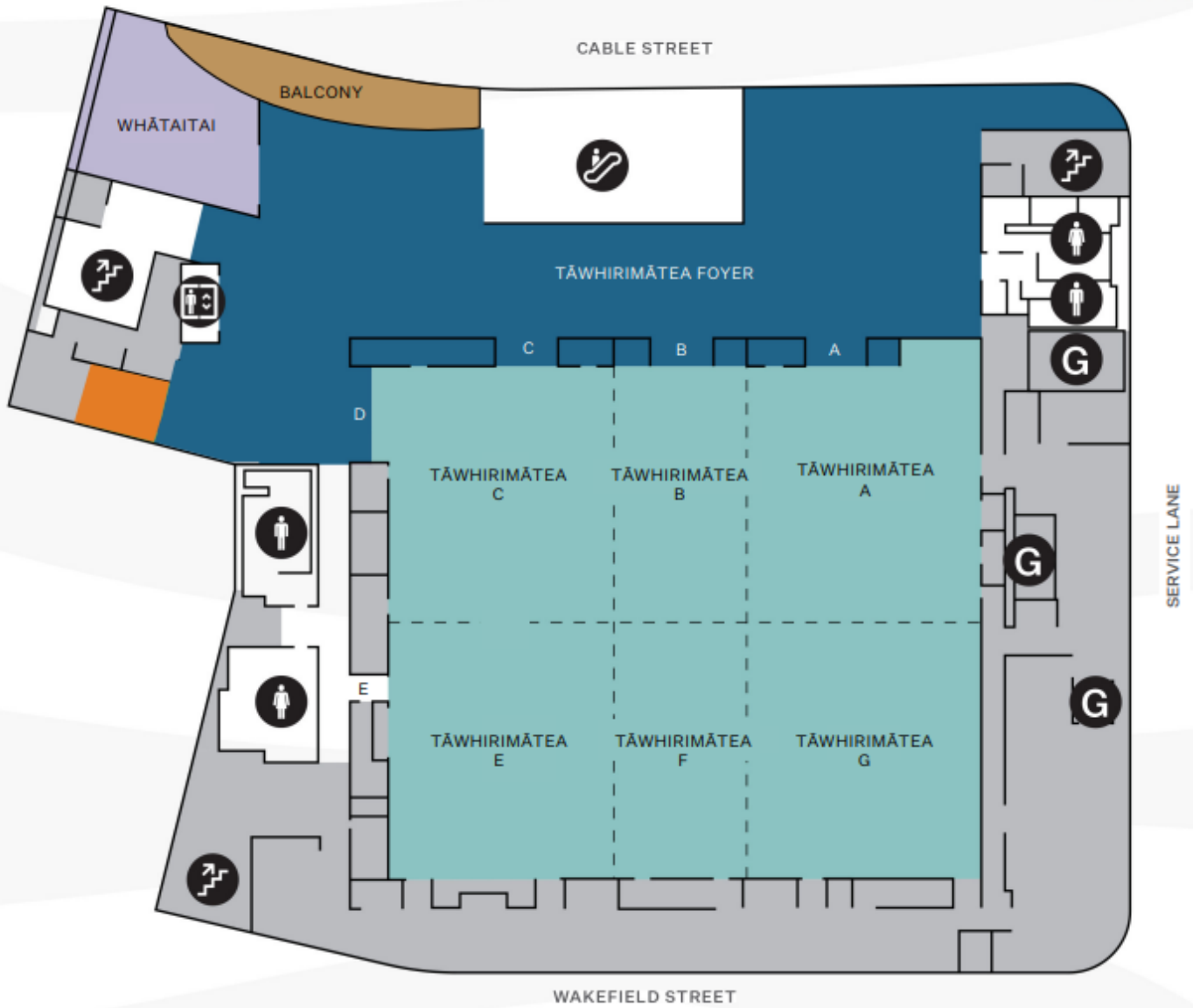

	STAIRS		TĀWHIRIMĀTEA		BALCONY
	LIFT		TĀWHIRIMĀTEA FOYER		ORGANISER OFFICE
	ESCALATOR		WHĀTAITAI		BACK OF HOUSE
	GOODS LIFT				
	TOILET				

## TĀWHIRIMĀTEA FOYER

Audio Reinforcement System	1	QSC DSP, Amplifier, 36 x QSC AD-C6T ceiling speakers
Control System	1	QSC Control and QSC Touch Panels
Room Lighting	1	House Lights

## TĀWHIRIMĀTEA C

Projection Screen	1	Screen Technics 325", 7.1m x 4m (16:9 ratio)
16000 Lumen High Brightness Laser Projector, Flown	1	Panasonic PT-MZ16KL WUXGA
Presentation Computer installed in Rack	1	HP SFF PC
Audio Reinforcement System	1	QSC DSP, Amplifiers, 2 x QSC KLA12 Program line array pairs, 2 x QSC KLA181 Subs, 15 x QSC AD-C6T ceiling speakers
Control System, Touch Panel, Wall Mounted	2	QSC Control and QSC Touch Panels
Room Lighting	1	House Lights
Digital Signage Lectern	1	Lectrum L20, Panasonic 43" monitor & Brightsign
Lectern Microphone	1	Shure 412/C-X
Black Laptop Plinth	1	Portable (Lockable Wheels)
Presentation Remote Slide Advancer with Laser Pointer	1	Logitech R700
Keyboard and Mouse	1	HP wireless keyboard and mouse, Extron USB extender
Presenter Foldback Monitor Screen 22inch	1	HP z22, SVSI receiver
HDMI Input at Lectern for Guest Device	1	SVSI Wallplate
PC Audio for Guest Device	1	SVSI Wallplate
Wireless Handheld Microphone	2	Shure MXW2/SM58
Wireless Lapel Microphone	1	Shure MXW1/WL184

## TĀWHIRIMĀTEA B

Audio Reinforcement System	1	QSC DSP, Amplifiers, 2 x QSC K122 Program speakers, 10 x QSC AD-C6T ceiling speakers
Control System, Touch Panel, Wall Mounted	1	QSC Control and QSC Touch Panel
Room Lighting	1	House Lights
HDMI Input for Guest Device	1	SVSI Wallplate
PC Audio for Guest Device	1	SVSI Wallplate
Wireless Handheld Microphone	1	Shure MXW2/SM58
Wireless Lapel Microphone	1	Shure MXW1/WL184

## TĀWHIRIMĀTEA A

Projection Screen	1	Screen Technics 325", 7.1m x 4m (16:9 ratio)
20000 Lumen High Brightness Laser Projector, Flown	1	Panasonic PT-RZ21KE WUXGA
Presentation Computer installed in Rack	1	HP SFF PC
Audio Reinforcement System	1	QSC DSP, Amplifiers, 2 x QSC KLA12 Program line array pairs, 2 x QSC KLA181 Subs, 15 x QSC AD-C6T ceiling speakers
Control System, Touch Panel, Wall Mounted	2	QSC Control and QSC Touch Panels
Room Lighting	1	House Lights
Digital Signage Lectern	1	Lectrum L20, Panasonic 43" monitor & Brightsign
Lectern Microphone	1	Shure 412/C-X
Black Laptop Plinth	1	Portable (Lockable Wheels)
Presentation Remote Slide Advancer with Laser Pointer	1	Logitech R700
Keyboard and Mouse	1	HP wireless keyboard and mouse, Extron USB extender
Presenter Foldback Monitor Screen 22inch	1	HP z22, SVSI receiver
HDMI Input at Lectern for Guest Device	1	SVSI Wallplate
PC Audio for Guest Device	1	SVSI Wallplate
Wireless Handheld Microphone	2	Shure MXW2/SM58
Wireless Lapel Microphone	1	Shure MXW1/WL184



## TĀWHIRIMĀTEA E

Projection Screen	1	Screen Technics 325", 7.1m x 4m (16:9 ratio)
16000 Lumen High Brightness Laser Projector, Flown	1	Panasonic PT-MZ16KL WUXGA
Presentation Computer installed in Rack	1	HP SFF PC
Audio Reinforcement System	1	QSC DSP, Amplifiers, 2 x QSC KLA12 Program line array pairs, 2 x QSC KLA181 Subs, 15 x QSC AD-C6T ceiling speakers
Control System, Touch Panel, Wall Mounted	2	QSC Control and QSC Touch Panels
Room Lighting	1	House Lights
Digital Signage Lectern	1	Lectrum L20, Panasonic 43" monitor & Brightsign
Lectern Microphone	1	Shure 412/C-X
Black Laptop Plinth	1	Portable (Lockable Wheels)
Presentation Remote Slide Advancer with Laser Pointer	1	Logitech R700
Keyboard and Mouse	1	HP wireless keyboard and mouse, Extron USB extender
Presenter Foldback Monitor Screen 22inch	1	HP z22, SVSI receiver
HDMI Input at Lectern for Guest Device	1	SVSI Wallplate
PC Audio for Guest Device	1	SVSI Wallplate
Wireless Handheld Microphone	2	Shure MXW2/SM58
Wireless Lapel Microphone	1	Shure MXW1/WL184

## TĀWHIRIMĀTEA F

Audio Reinforcement System	1	QSC DSP, Amplifiers, 2 x QSC K122 Program speakers, 10 x QSC AD-C6T ceiling speakers
Control System, Touch Panel, Wall Mounted	1	QSC Control and QSC Touch Panel
Room Lighting	1	House Lights
HDMI Input for Guest Device	1	SVSI Wallplate
PC Audio for Guest Device	1	SVSI Wallplate

## TĀWHIRIMĀTEA G

Projection Screen	1	Screen Technics 325", 7.1m x 4m (16:9 ratio)
20000 Lumen High Brightness Laser Projector, Flown	1	Panasonic PT-RZ21KE WUXGA
Presentation Computer installed in Rack	1	HP SFF PC
Audio Reinforcement System	1	QSC DSP, Amplifiers, 2 x QSC KLA12 Program line array pairs, 2 x QSC KLA181 Subs, 15 x QSC AD-C6T ceiling speakers
Control System, Touch Panel, Wall Mounted	2	QSC Control and QSC Touch Panels
Room Lighting	1	House Lights
Digital Signage Lectern	1	Lectrum L20, Panasonic 43" monitor & Brightsign
Lectern Microphone	1	Shure 412/C-X
Black Laptop Plinth	1	Portable (Lockable Wheels)
Presentation Remote Slide Advancer with Laser Pointer	1	Logitech R700
Keyboard and Mouse	1	HP wireless keyboard and mouse, Extron USB extender
Presenter Foldback Monitor Screen 22inch	1	HP z22, SVSI receiver
HDMI Input at Lectern for Guest Device	1	SVSI Wallplate
PC Audio for Guest Device	1	SVSI Wallplate
Wireless Handheld Microphone	2	Shure MXW2/SM58
Wireless Lapel Microphone	1	Shure MXW1/WL184

## TĀWHIRIMĀTEA C & E

Projection Screen	2	Screen Technics 325", 7.1m x 4m (16:9 ratio)
16000 Lumen High Brightness Laser Projector, Flown	2	Panasonic PT-MZ16KL WUXGA
Presentation Computer installed in Rack	1	HP SFF PC
Audio Reinforcement System	1	QSC DSP, Amplifiers, 4 x QSC KLA12 Program line array pairs, 4 x QSC KLA181 Subs, 30 x QSC AD-C6T ceiling speakers
Control System, Touch Panel, Wall Mounted	2	QSC Control and QSC Touch Panels
Room Lighting	1	House Lights
Digital Signage Lectern	1	Lectrum L20, Panasonic 43" monitor & Brightsign
Lectern Microphone	1	Shure 412/C-X
Black Laptop Plinth	1	Portable (Lockable Wheels)
Presentation Remote Slide Advancer with Laser Pointer	1	Logitech R700
Keyboard and Mouse	1	HP wireless keyboard and mouse, Extron USB extender
Presenter Foldback Monitor Screen 22inch	1	HP z22, SVSI receiver
HDMI Input at Lectern for Guest Device	1	SVSI Wallplate
PC Audio for Guest Device	1	SVSI Wallplate
Wireless Handheld Microphone	4	Shure MXW2/SM58
Wireless Lapel Microphone	2	Shure MXW1/WL184

## TĀWHIRIMĀTEA A & G

Projection Screen	2	Screen Technics 325", 7.1m x 4m (16:9 ratio)
20000 Lumen High Brightness Laser Projector, Flown	2	Panasonic PT-RZ21KE WUXGA
Presentation Computer installed in Rack	1	HP SFF PC
Audio Reinforcement System	1	QSC DSP, Amplifiers, 4 x QSC KLA12 Program line array pairs, 4 x QSC KLA181 Subs, 30 x QSC AD-C6T ceiling speakers
Control System, Touch Panel, Wall Mounted	2	QSC Control and QSC Touch Panels
Room Lighting	1	House Lights
Digital Signage Lectern	1	Lectrum L20, Panasonic 43" monitor & Brightsign
Lectern Microphone	1	Shure 412/C-X
Black Laptop Plinth	1	Portable (Lockable Wheels)
Presentation Remote Slide Advancer with Laser Pointer	1	Logitech R700
Keyboard and Mouse	1	HP wireless keyboard and mouse, Extron USB extender
Presenter Foldback Monitor Screen 22inch	1	HP z22, SVSI receiver
HDMI Input at Lectern for Guest Device	1	SVSI Wallplate
PC Audio for Guest Device	1	SVSI Wallplate
Wireless Handheld Microphone	4	Shure MXW2/SM58
Wireless Lapel Microphone	2	Shure MXW1/WL184

## TĀWHIRIMĀTEA FULL

Projection Screen	2	Screen Technics 325", 7.1m x 4m (16:9 ratio)
20000 Lumen High Brightness Laser Projector, Flown	2	Panasonic PT-RZ21KE WUXGA
Presentation Computer installed in Rack	1	HP SFF PC
Audio Reinforcement System	1	QSC DSP, Amplifiers, 4 x QSC KLA12 Program line array pairs, 4 x QSC KLA181 Subs, 80 x QSC AD-C6T ceiling speakers
Control System, Touch Panel, Wall Mounted	2	QSC Control and QSC Touch Panels
Room Lighting	1	House Lights
Digital Signage Lectern	1	Lectrum L20, Panasonic 43" monitor & Brightsign
Lectern Microphone	1	Shure 412/C-X
Black Laptop Plinth	1	Portable (Lockable Wheels)
Presentation Remote Slide Advancer with Laser Pointer	1	Logitech R700
Keyboard and Mouse	1	HP wireless keyboard and mouse, Extron USB extender
Presenter Foldback Monitor Screen 22inch	1	HP z22, SVSI receiver
HDMI Input at Lectern for Guest Device	1	SVSI Wallplate
PC Audio for Guest Device	1	SVSI Wallplate
Wireless Handheld Microphone	8	Shure MXW2/SM58
Wireless Lapel Microphone	4	Shure MXW1/WL184

## WHĀTAITAI 2A

Projection Screen	1	Screen Technics 200", 4.4m x 2.5m (16:9 ratio)
12000 Lumen High Brightness Laser Projector, Flown	1	Panasonic PT-RZ120 WUXGA
Presentation Computer installed in Rack	1	HP SFF PC
Audio Reinforcement System	1	QSC DSP, Amplifiers, 2 x QSC KW-122 Program speakers 8 x QSC AD-C6Tceiling speakers
Control System, Touch Panel, Wall Mounted	2	QSC Control and QSC Touch Panels
Room Lighting	1	House Lights
Digital Signage Lectern	1	Lectrum L20, Panasonic 43" monitor & Brightsign
Lectern Microphone	1	Shure 412/C-X
Black Laptop Plinth	1	Portable (Lockable Wheels)
Presentation Remote Slide Advancer with Laser Pointer	1	Logitech R700
Keyboard and Mouse	1	HP wireless keyboard and mouse, Extron USB extender
Presenter Foldback Monitor Screen 22inch	1	HP z22, SVSI receiver
HDMI Input at Lectern for Guest Device	1	SVSI Wallplate
PC Audio for Guest Device	1	SVSI Wallplate
Wireless Handheld Microphone	2	Shure MXW2/SM58
Wireless Lapel Microphone	1	Shure MXW1/WL184